

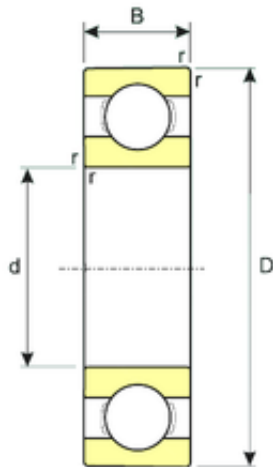

MANUFACTURING MEXICO,S.A.DE C.V.



4 mm x 9 mm x 2,5 mm ISB 684 deep groove ball bearings

Bearing No. 684

Size	4x9x2.5 mm
Bore Diameter	4 mm
Outer Diameter	9 mm
Width	2,5 mm
d	4 mm
D	9 mm
B	2,5 mm
C	2,5 mm
r min.	0,15 mm
Basic dynamic load rating (C)	0,49 kN

684 Bearing 2D drawings and 3D CAD models