

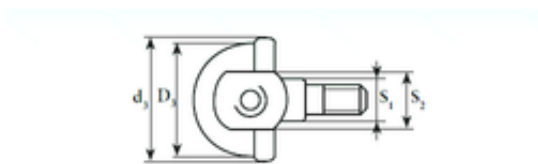

MANUFACTURING MEXICO,S.A.DE C.V.

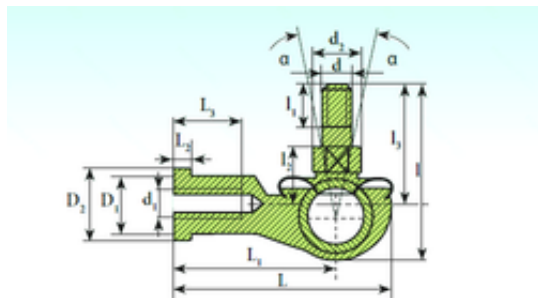

ISB SQ 8 C RS plain bearings

Bearing No. SQ 8 C RS

| | |
|-------------------------------|----------|
| d | 8 mm |
| S1 | 10 mm |
| L2 | 5 mm |
| L3 | 17 mm |
| l | 42,5 mm |
| d2 | 12 mm |
| d3 | 24 mm |
| l1 min. | 12 mm |
| l2 max. | 14 mm |
| l3 min. | 31 mm |
| D1 | 12,5 mm |
| D2 | 16 mm |
| D3 | 23 mm |
| L | 48 mm |
| L1 | 36 mm |
| S2 | 14 mm |
| Thread (G) | M8x1,25 |
| Angle | 25 ° |
| Weight | 0,068 Kg |
| Basic dynamic load rating (C) | 5,7 kN |

SQ 8 C RS Bearing 2D drawings and 3D CAD models