

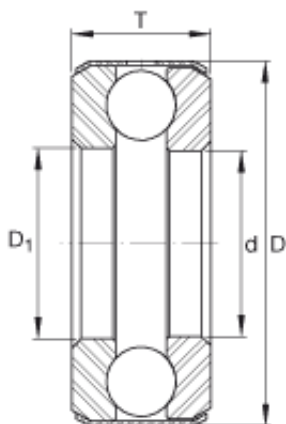

MANUFACTURING MEXICO,S.A.DE C.V.



INA D4 thrust ball bearings

Bearing No. D4

| | |
|----------------------|--|
| Size | 17.463x34.138x14.3 mm |
| Bore Diameter | 17,463 mm |
| Outer Diameter | 34,138 mm |
| Width | 14,3 mm |
| d | 11/16 inch |
| d | 17,463 mm |
| D | 1,344 inch |
| D | 34,138 mm |
| T | 0,563 inch |
| T | 14,3 mm |
| D ₁ | 0,719 inch |
| m | 0,13 lbs / Weight |
| m | 60 g / Weight |
| C _a | 4100 lbf / Dynamic load rating (axial) |
| C _a | 18200 N / Dynamic load rating (axial) |
| C _{0a} | 6700 lbf / Static load rating (axial) |
| C _{0a} | 29800 N / Static load rating (axial) |
| Category | Thrust Ball Bearing |
| Inventory | 0.0 |
| Manufacturer Name | SCHAEFFLER GROUP |
| Minimum Buy Quantity | N/A |
| Weight / Kilogram | 0.072 |
| Product Group | B00308 |
| | |

D4 Bearing 2D drawings and 3D CAD models



MANUFACTURING MEXICO,S.A.DE C.V.

| | |
|-------------------------------------|--|
| Rolling Element | Ball Bearing |
| Thrust Bearing | Yes |
| Single or Double Direction | Single Direction |
| Banded | Yes |
| Precision Class | ABEC 1 ISO P0 |
| Component Description | Roller Assembly Plus Raceways |
| Other Features | Single Row Deep Groove Medium Cross Section Grooved Race Non Separable Full Complement Standard Oil Hole in Band |
| Long Description | 11/16" Bore 1; 23/32" Bore 2; 1-11/32" Outside Diameter; 9/16" Height; Ball Bearing; Single Direction; Banded; ABEC 1 ISO P0 Precision |
| Inch - Metric | Inch |
| Category | Thrust Ball Bearings |
| UNSPSC | 31171507 |
| Harmonized Tariff Code | 8482.10.50.08 |
| Noun | Bearing |
| Keyword String | Ball Thrust |
| Manufacturer URL | http://www.ina.com |
| Manufacturer Item Number | D4AKL |
| Weight / LBS | 0.13 |
| Bore 1 | 0.688 Inch 17.475 Millimeter |
| Outside Diameter | 1.344 Inch 34.138 Millimeter |
| Bore 2 | 0.719 Inch 18.263 Millimeter |
| Overall Height with Aligning Washer | 0 Inch 0 Millimeter |
| Height | 0.563 Inch 14.3 Millimeter |



MANUFACTURING MEXICO,S.A.DE C.V.