

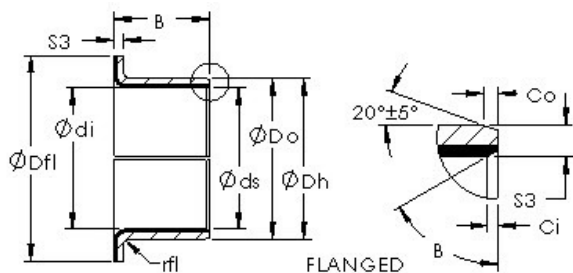

MANUFACTURING MEXICO,S.A.DE C.V.



AST AST11 F22200 plain bearings

Bearing No. AST11 F22200

Bore Diameter	22 mm
Outer Diameter	25 mm
Bearing Type	flanged
Shaft Dia., Nominal (d)	22.0000
Shaft Size (ds) - 22 -0.02 / -0.041	22 0.02 / 0.041
Housing Bore Dia. (Dh)	25 +0.021 / +0
Bearing Outside Diameter, Nominal(Do)	25.000
Bearing Outside Diameter Tolerance (Do tol.)	25.075 / 25.035
Bearing Bore after Mounting (di)	22.071 / 21.99
Average Clearance (Cd)	0.0610
Wall Thickness (S3)	1.505
Bearing Length, Nominal (B)	20.000
Bearing Length Tolerance (B tol.) - +0.25 / -0.25	+0.25 / 0.25
OD Chamfer Length (Co)	0.700
ID Chamfer Angle (B deg.)	30
ID Chamfer Length (Ci)	0.500
Flange Dia. (Dfl pm 0.5)	32.000
Flange Radius (rfl)	1.500
Material	Bronze shell with PTFE / Fiber lining

AST11 F22200 Bearing 2D drawings and 3D CAD models